

**vtech**<sup>®</sup>

**User's Manual**

## **Splash & Swim Penguin**



© 2016 VTech  
All rights reserved  
**Printed in China**  
91-003303-000<sup>UK</sup>

**VTech understands that a child's needs and abilities change as they grow and with that in mind we develop our toys to teach and entertain at just the right level...**

## **vtech** Baby

**Toys that will stimulate their interest in different textures, sounds and colours**

### **I am...**

...responding to colours, sounds and textures

...understanding cause and effect

...learning to touch, reach, grasp, sit-up, crawl and toddle

*Birth-36 months*



## **Pre-School**

**Interactive toys to develop their imagination and encourage language development**

### **I want...**

...to get ready for school by starting to learn the alphabet and counting

...my learning to be as fun, easy and exciting as can be

...to show my creativity with drawing and music so my whole brain develops

*3-6 years*



## **Electronic Learning Computers**

**Cool, aspirational and inspiring computers for curriculum related learning**

### **I need...**

...challenging activities that can keep pace with my growing mind

...intelligent technology that adapts to my level of learning

...National Curriculum based content to support what I'm learning at school

*4-10 years*



To learn more about this and other VTech® products, visit [www.vtech.co.uk](http://www.vtech.co.uk)

# INTRODUCTION

Thank you for purchasing the **VTech® Splash & Swim Penguin** learning toy!

The **VTech® Splash & Swim Penguin** is a cute bath toy for toddlers to play with during bath time. Toddlers can press the penguin's light up mask button to be rewarded with fun phrases, sounds and short tunes. They can also twist the starfish on the penguin's tummy to see the penguin splash and swim in the water! Enjoy the **VTech® Splash & Swim Penguin**!

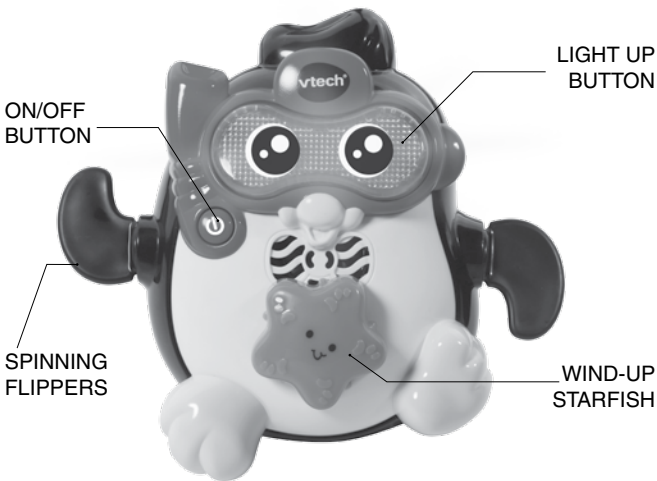

# INCLUDED IN THIS PACKAGE

- One VTech® Splash & Swim Penguin
- One user's manual

**WARNING:** All packing materials, such as tape, plastic sheets, packaging locks and tags are not part of this toy, and should be discarded for your child's safety.

**NOTE:** Please keep this user's manual as it contains important information.

## Unlock the packaging locks:

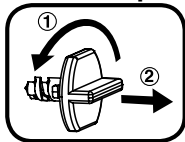

- ① Turn the packaging lock anticlockwise several times.
- ② Pull out and discard the packaging lock.

# GETTING STARTED

## BATTERY INSTALLATION

1. Make sure the unit is turned OFF.
2. Locate the battery cover on the bottom of the unit. Use a screwdriver to loosen the screw.
3. Install 1 new AAA (AM-4/LR03) battery following the diagram inside the battery box. (The use of new alkaline batteries is recommended for maximum performance).
4. Replace the battery cover and tighten the screw to secure.
5. When closing the battery cover, please ensure that the screws are securely tightened to avoid any water leakage.

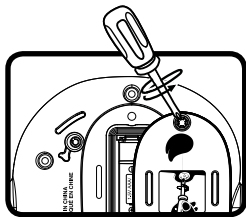

**PLEASE NOTE:** The speaker must be kept above water. If the speaker fills up with water, remove the penguin from the water as soon as possible and allow the water to drain away from the speaker.

## BATTERY NOTICE

- Use new alkaline batteries or fully charged NI-MH (Nickel Metal-hydride) rechargeable batteries for best performance.
- Use only batteries of the same or equivalent type as recommended.
- Do not mix different types of batteries: alkaline, standard (carbon-zinc) or rechargeable (Ni-Cd, Ni-MH), or new and used batteries.
- Do not use damaged batteries.
- Insert batteries with the correct polarity.
- Do not short-circuit the battery terminals.
- Remove exhausted batteries from the toy.
- Remove batteries during long periods of non-use.
- Do not dispose of batteries in fire.
- Do not charge non-rechargeable batteries.
- Remove rechargeable batteries from the toy before charging (if removable).
- Rechargeable batteries are only to be charged under adult supervision.

### Disposal of batteries and product



The crossed-out wheeled bin symbols on products and batteries, or on their respective packaging, indicates they must not be disposed of in domestic waste as they contain substances that can be damaging to the environment and human health.



The chemical symbols Hg, Cd or Pb, where marked, indicate that the battery contains more than the specified value of mercury (Hg), cadmium (Cd) or lead (Pb) set out in Battery Directive (2006/66/EC).

The solid bar indicates that the product was placed on the market after 13th August, 2005.

Help protect the environment by disposing of your product or batteries responsibly.

For more information, please visit:

[www.recycle-more.co.uk](http://www.recycle-more.co.uk)

[www.recyclenow.com](http://www.recyclenow.com)

# PRODUCT FEATURES

## 1. ON/OFF BUTTON

Press the ON/OFF BUTTON for approximately a second to turn the unit ON. To turn the unit OFF, press the ON/OFF BUTTON again for approximately a second.



## 2. AUTOMATIC SHUT OFF



To preserve battery life, the VTech® **Splash & Swim Penguin** will automatically power down after approximately a minute without input. The unit can be turned on again by pressing the LIGHT UP BUTTON or by pressing the ON/OFF BUTTON for approximately a second.

NOTE: If the unit powers down while playing, we suggest changing the batteries.

## WARNINGS:

- The batteries must be changed by an adult.
- This toy cannot be used in salt water.
- After using this toy, do not leave it in the water for a long time.
- Make sure to empty the water out of all elements of the toy and to rinse them out before drying.
- This toy can be operated in water only when fully assembled in accordance with the instructions.
- This is not a lifesaving device. Do not leave your child unattended while this **VTech® Splash & Swim Penguin** unit is in use.
- Never leave a child unattended or with an older child in the bathroom or in the bath, not even for one minute.
- Always check with a thermometer the temperature of the water coming from the tap before sitting your child in the bath. Toddlers have very sensitive skin and can easily get burnt if the water is too hot.
- When closing the battery cover ensure that the screw is securely tightened. This will avoid any water leakage.
- Only use this unit in water between 10 and 45 degrees centigrade.
- Parents should drain the water from the speaker if the volume decreases too much.

# ACTIVITIES

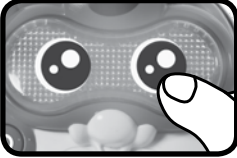
1. Press the ON/OFF BUTTON for approximately a second to turn the unit ON, you will hear a song, followed by a fun phrase and a sound. The light will flash with the sounds.
2. Twist the starfish clockwise and release to make the flippers spin and watch the penguin swim.
3. Press the LIGHT UP BUTTON to hear fun phrases, songs, sounds or melodies. The light will flash with the sounds.
4. Press the LIGHT UP BUTTON quickly and continuously while a melody is playing to hear fun sounds play over the tune. The light will flash with the sounds.
5. Pressing the LIGHT UP BUTTON quickly and continuously will play fun sound effects. Press and hold down the LIGHT UP BUTTON to hear a fun phrase.
6. Press the ON/OFF BUTTON for approximately a second again to turn the unit OFF. You will hear a closing tune before the unit switches off. The light will flash with the sounds.

## SING-ALONG SONG LYRICS

### SONG 1

My flippers are like wings, but I can't fly.  
I flap and I kick when I swim!

### SONG 2

I have a starfish on my tummy.  
My starfish and I are very chummy.  
We spin, we swim, and wave as we go by!

## MELODY LIST

1. Aiken Drum
2. Daring Young Man on the Flying Trapeze
3. For He's a Jolly Good Fellow
4. Here We Go Looby Loo
5. Polly Wolly Doodle
6. Sailing, Sailing
7. Sing a Song of Sixpence
8. Ta Ra Ra Boom De Ay
9. Toyland
10. Twinkle, Twinkle, Little Star

## CARE & MAINTENANCE

1. Keep the unit clean by wiping it with a slightly damp cloth.
2. Keep the unit out of direct sunlight and away from any direct heat source.
3. Remove the batteries when the unit will not be in use for an extended period of time.
4. Please drain all water from the unit, and ensure that the unit has been rinsed thoroughly before it is dried, so that all sediment and/or cleaning products have been removed.
5. Please ensure that all elements of the unit are dry before storing it away. Do not drop the unit on hard surfaces.

## TROUBLESHOOTING

If for some reason the program/activity stops working or malfunctions, please follow these steps:

1. Please turn the unit OFF.
2. Interrupt the power supply by removing the batteries.
3. Let the unit stand for a few minutes, then replace the batteries.
4. Turn the unit ON. The unit should now be ready to play again.
5. If the product still does not work, replace the batteries with an entire new set of batteries.

If the problem persists, please call our Consumer Services Department on 01235 546810 (from UK) or +44 1235 546810 (outside UK) and a service representative will be happy to help you.



# TECHNICAL SUPPORT

If you have a problem that cannot be solved by using this manual, we encourage you to visit us online or contact our Consumer Services Department with any problems and/or suggestions that you might have. A support representative will be happy to assist you.

Before requesting support, please be ready to provide or include the information below:

- The name of your product or model number (the model number is typically located on the back or bottom of your product).
- The actual problem you are experiencing.
- The actions you took right before the problem started.

Internet: [www.vtech.co.uk](http://www.vtech.co.uk)

Phone: 01235 546810 (from UK), or +44 1235 546810 (outside UK)

## IMPORTANT NOTE:

Creating and developing VTech® products is accompanied by a responsibility that we take very seriously. We make every effort to ensure the accuracy of the information, which forms the value of our products. However, errors sometimes can occur. It is important for you to know that we stand behind our products and encourage you to call our Consumer Services Department on 01235 546810 (from UK), or +44 1235 546810 (outside UK), with any problems and/or suggestions that you might have. A service representative will be happy to help you.

**CLASS 1  
LED PRODUCT**



# PRODUCT REGISTRATION

Visit [www.vtech.co.uk/clubvtech/login](http://www.vtech.co.uk/clubvtech/login)  
to register your VTech product

By joining the VTech Club you can also enter competitions, find out about news and events, seek expert advice for parents and let your kids play fun learning games and activities.



## PRODUCT WARRANTY

Thank you for choosing this quality product from VTech. We hope it will bring many hours of entertainment, imaginative play and learning.

1. The product detailed above is covered by a one year warranty from the date of purchase, against any defects in materials or workmanship.
2. The product may be returned to the place of purchase. Alternatively the product can be returned to VTech Electronics Europe plc (see address below), with proof of purchase, without proof of purchase no replacement will be provided.
3. VTech Electronics Europe plc will examine the product and if it is found to be defective due to faulty materials or workmanship, will replace the product at their discretion.
4. If the product covered by this warranty is damaged due to misuse, modification or unauthorised repair, or because of faulty batteries, battery discharge or incorrect electrical connections, then this warranty becomes void.
5. This warranty is personal to the original purchaser and is not transferable.
6. Breakages to the LCD screen are not covered by the warranty.
7. Returns to VTech Electronics Europe plc should include a cheque or postal order for £1.50 towards the cost of return postage and packaging.
8. Products returned to VTech Electronics Europe plc, should be addressed as follows and packed carefully to avoid damage in transit (Please do not include batteries or adaptor). Please include details of the fault together with your name and address.
9. To keep an online record of your warranty, please register your product online at [www.vtech.co.uk/warranty](http://www.vtech.co.uk/warranty)

Vtech Electronics EU PLC, c/o XPO Logistics, Warehouse 350, Cat & Fiddle Lane, West Hallam, DE7 6HE

**THIS WARRANTY IS OFFERED AS AN EXTRA BENEFIT AND DOES NOT AFFECT CONSUMERS' STATUTORY RIGHTS.**

This warranty is valid for the UK and Eire only. For products purchased outside the UK and Eire, please contact your local distributor or place of purchase.

